

## Performance curves

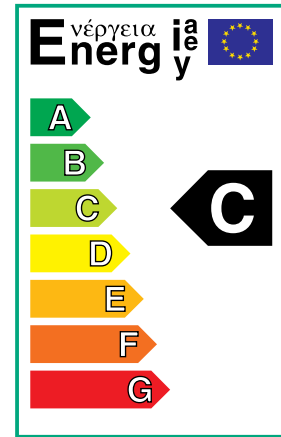

TM04 2616 2808- TM03 0868 0705

## Dimensional sketches

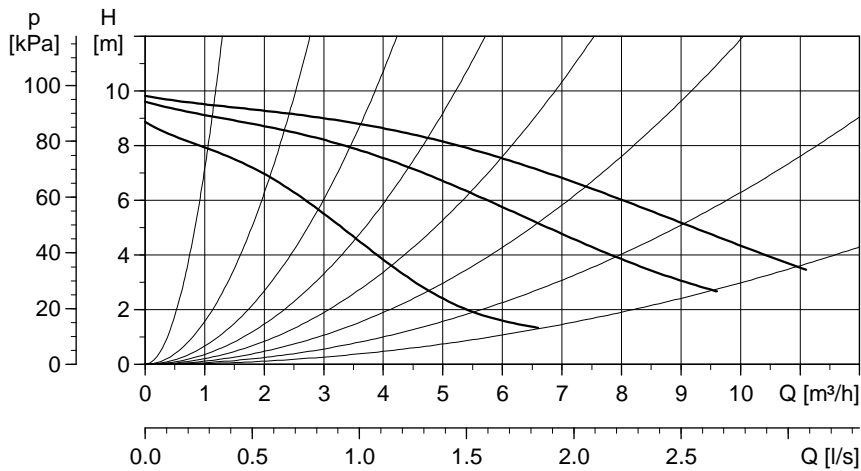
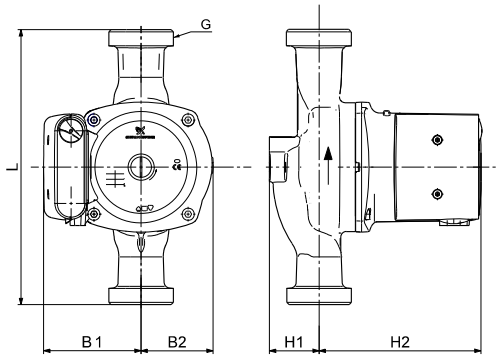

TM04 2809 3408

## Dimensions

L [mm]	180
H1 [mm]	47
H2 [mm]	150
B1 [mm]	90
B2 [mm]	68
G	1 1/2

## Electrical data 1x 230 V

Speed	P <sub>1</sub> [W]	I <sub>1/1</sub> [A]
3	345	1,52
2	340	1,50
1	280	1,30

## Approvals

### Motor protection

The pump has a built-in thermal switch and requires no additional motor protection.

### Enclosure class

IP 44.

### Position of terminal box

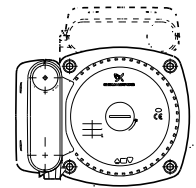

TM04 2810 3408

### Liquid temperature

-25 °C to +110 °C (TF 110).

### Weights and volume

Net weight [kg]	6,3
Gross weight [kg]	6,9
Shipping volume [m <sup>3</sup> ]	0,012